



aeon

DUBAI CREEK HARBOUR

FLOOR PLAN - TOWER 1

EMAAR

aeon

DUBAI CREEK HARBOUR

TOWER 1

1 BEDROOM

LEVEL 1 UNIT 01_01
& 04

SUITE AREA	498.36 SQ.FT	44.88 SQ.M.
BALCONY AREA	45.01 SQ.FT	4.14 SQ.M.
TOTAL AREA	743.37 SQ.FT	69.02 SQ.M.



KEY PLAN LEVEL



KEY SECTION



Disclaimer: 1. All dimensions are in imperial and metric, and measured from finish to finish excluding construction tolerances. 2. All materials, dimensions, and drawings are approximate only. 3. Information is subject to change without notice, at developer's absolute discretion. 4. Actual area may vary from the stated area. 5. Drawings not to scale. 6. All images used are for illustrative purposes only and do not represent the actual size, features, specifications, fittings, and furnishings. 7. The developer reserves the right to make revisions / alterations, in its absolute discretion, without any liability whatsoever.

EMAAR

aeon

DUBAI CREEK HARBOUR

TOWER 1

1 BEDROOM

LEVEL 7-15: UNIT 04, 05 & 06

SUITE AREA	698.33 SQ.FT	64.97 SQ.M.
BALCONY AREA	52.03 SQ.FT	4.91 SQ.M.
TOTAL AREA	750.36 SQ.FT	70.97 SQ.M.



KEY PLAN LEVEL

7-15



KEY SECTION



Disclaimer: All dimensions are in imperial and metric, and measured from finish to finish excluding construction tolerances. 2. All materials, dimensions, and drawings are approximate only. 3. Information is subject to change without notice. 4. Developer's double dimension. 5. Actual area may vary from the stated area. 6. Drawings not to scale. 7. All images used are for illustrative purposes only and do not represent the actual site, features, specifications, fittings, and furnishings. 7. The developer reserves the right to make revisions / alterations, at its absolute discretion, without any liability whatsoever.

EMAAR

aeon

DUBAI CREEK HARBOUR

TOWER 1

1 BEDROOM

FLOOR 16-19 UNIT 16 & 19

SUITE AREA	498.27 SQ.FT	44.87 SQ.M.
BALCONY AREA	42.03 SQ.FT	3.91 SQ.M.
TOTAL AREA	540.30 SQ.FT	50.07 SQ.M.

KEY PLAN LEVEL

16-19



KEY SECTION



Disclaimer: 1. All dimensions are in imperial and metric, and measured from finish to finish excluding construction tolerances. 2. All materials, dimensions, and drawings are approximate only. 3. Information is subject to change without notice, in developer's absolute discretion. 4. Actual area may vary from the stated area. 5. Drawings not to scale. 6. All images used are for illustrative purposes only and do not represent the actual site, features, specifications, fittings, and furnishings. 7. The developer reserves the right to make revisions / alterations, in its absolute discretion, without any liability whatsoever.

EMAAR

aeon

DUBAI CREEK HARBOUR

TOWER 1

1 BEDROOM

FLOOR 20

DATE: 04/16/20

SUITE AREA	498.36 SQ.FT	64.84 SQ.M.
BALCONY AREA	52.03 SQ.FT	6.95 SQ.M.
TOTAL AREA	550.41 SQ.FT	71.81 SQ.M.

KEY PLAN LEVEL

20

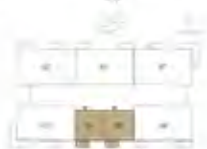

KEY SECTION



Disclaimer: 1. All dimensions are in imperial and metric, and measured from finish to finish excluding construction tolerances. 2. All materials, dimensions, and drawings are approximate only. 3. Information is subject to change without notice, in developer's absolute discretion. 4. Actual area may vary from the stated area. 5. Drawings not to scale. 6. All images used are for illustrative purposes only and do not represent the actual size, features, specifications, fittings, and furnishings. 7. The developer reserves the right to make revisions / alterations, in its absolute discretion, without any liability whatsoever.

EMAAR

aeon

DUBAI CREEK HARBOUR

TOWER 1

2 BEDROOMS

LEVEL 1 UNIT 01

SUITE AREA	1161.93 SQ.FT.	107.91 SQ.M.
BALCONY AREA	173.30 SQ.FT.	16.10 SQ.M.
TOTAL AREA	1335.23 SQ.FT.	124.01 SQ.M.



KEY PLAN LEVEL



KEY SECTION



Disclaimer: 1. All dimensions are in imperial and metric, and measured from finish to finish excluding construction tolerances. 2. All materials, dimensions, and drawings are approximate only. 3. Information is subject to change without notice, in developer's absolute discretion. 4. Actual area may vary from the stated area. 5. Drawings not to scale. 6. All images used are for illustrative purposes only and do not represent the actual size, features, specifications, fittings, and furnishings. 7. The developer reserves the right to make revisions / alterations, in its absolute discretion, without any liability whatsoever.

EMAAR

aeon

DUBAI CREEK HARBOUR

TOWER 1

2 BEDROOMS

LEVELS 7-15 UNIT 01

SUITE AREA	1163.73 SQ.FT.	109.03 SQ.M.
BALCONY AREA	332.01 SQ.FT.	31.00 SQ.M.
TOTAL AREA	1544.74 SQ.FT.	144.00 SQ.M.



KEY PLAN LEVEL
7-15



KEY SECTION



Disclaimer: 1. All dimensions are in imperial and metric, and measured from finish to finish excluding construction tolerances. 2. All materials, dimensions, and drawings are approximate only. 3. Information is subject to change without notice, at developer's absolute discretion. 4. Actual area may vary from the stated area. 5. Drawings not to scale. 6. All images used are for illustrative purposes only and do not represent the actual size, features, specifications, fittings, and furnishings. 7. The developer reserves the right to make revisions / alterations, at its absolute discretion, without any liability whatsoever.

EMAAR

aeon

DUBAI CREEK HARBOUR

TOWER 1

2 BEDROOMS

LEVELS 7-15 : UNIT 08

SUITE AREA	1147.03 SQ.FT.	108.47 SQ.M.
BALCONY AREA	332.01 SQ.FT.	31.00 SQ.M.
TOTAL AREA	1479.03 SQ.FT.	139.48 SQ.M.



KEY PLAN LEVEL
7-15



KEY SECTION



Disclaimer: 1. All dimensions are in imperial and metric, and measured from finish to finish excluding construction tolerances. 2. All materials, dimensions, and drawings are approximate only. 3. Information is subject to change without notice, at developer's absolute discretion. 4. Actual area may vary from the stated area. 5. Drawings not to scale. 6. All images used are for illustrative purposes only and do not represent the actual size, features, specifications, fittings, and furnishings. 7. The developer reserves the right to make revisions / alterations, at its absolute discretion, without any liability whatsoever.

EMAAR

aeon

DUBAI CREEK HARBOUR

TOWER 1

2 BEDROOMS

LEVELS 7-15 UNIT 07

SUITE AREA	1169.71 SQ.FT.	109.47 SQ.M.
BALCONY AREA	73.47 SQ.FT.	6.84 SQ.M.
TOTAL AREA	1243.18 SQ.FT.	116.31 SQ.M.

KEY PLAN LEVEL
7-15

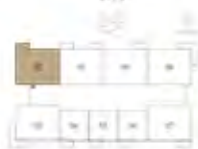

KEY SECTION



Disclaimer: 1. All dimensions are in imperial and metric, and measured from finish to finish excluding construction tolerances. 2. All materials, dimensions, and drawings are approximate only. 3. Information is subject to change without notice, in developer's absolute discretion. 4. Actual area may vary from the stated area. 5. Drawings not to scale. 6. All images used are for illustrative purposes only and do not represent the actual size, features, specifications, fittings, and furnishings. 7. The developer reserves the right to make revisions / alterations, in its absolute discretion, without any liability whatsoever.

EMAAR

aeon

DUBAI CREEK HARBOUR

TOWER 1

2 BEDROOMS

LEVELS 7-15 : UNIT 07

SUITE AREA	1143.07 SQ.FT.	107.06 SQ.M.
BALCONY AREA	73.47 SQ.FT.	6.84 SQ.M.
TOTAL AREA	1216.54 SQ.FT.	113.90 SQ.M.

KEY PLAN LEVEL
7-15



KEY SECTION



Disclaimer: 1. All dimensions are in imperial and metric, and measured from finish to finish excluding construction tolerances. 2. All materials, dimensions, and drawings are approximate only. 3. Information is subject to change without notice, in developer's absolute discretion. 4. Actual area may vary from the stated area. 5. Drawings not to scale. 6. All images used are for illustrative purposes only and do not represent the actual size, features, specifications, fittings, and furnishings. 7. The developer reserves the right to make revisions / alterations, in it's absolute discretion, without any liability whatsoever.

EMAAR

aeon

DUBAI CREEK HARBOUR

TOWER 1

2 BEDROOMS

LEVELS 7-15 : UNIT 09

SUITE AREA	1173.44 SQ.FT.	109.81 SQ.M.
BALCONY AREA	41.03 SQ.FT.	3.91 SQ.M.
TOTAL AREA	1214.47 SQ.FT.	113.74 SQ.M.



KEY PLAN LEVEL

7-15



KEY SECTION



Disclaimer: 1. All dimensions are in imperial and metric, and measured from finish to finish excluding construction tolerances. 2. All materials, dimensions, and drawings are approximate only. 3. Information is subject to change without notice, in developer's absolute discretion. 4. Actual area may vary from the stated area. 5. Drawings not to scale. 6. All images used are for illustrative purposes only and do not represent the actual size, features, specifications, fittings, and furnishings. 7. The developer reserves the right to make revisions / alterations, in it's absolute discretion, without any liability whatsoever.

EMAAR

aeon

DUBAI CREEK HARBOUR

TOWER 1

2 BEDROOMS

FLOOR 7-15 UNIT 01

SUITE AREA	1169.18 SQ.FT.	109.63 SQ.M.
BALCONY AREA	172.98 SQ.FT.	16.04 SQ.M.
TOTAL AREA	1342.16 SQ.FT.	125.67 SQ.M.



KEY PLAN LEVEL
7-15



KEY SECTION



Disclaimer: 1. All dimensions are in imperial and metric, and measured from finish to finish excluding construction tolerances. 2. All materials, dimensions, and drawings are approximate only. 3. Information is subject to change without notice, at developer's absolute discretion. 4. Actual area may vary from the stated area. 5. Drawings not to scale. 6. All images used are for illustrative purposes only and do not represent the actual size, features, specifications, fittings, and furnishings. 7. The developer reserves the right to make revisions / alterations, at its absolute discretion, without any liability whatsoever.

EMAAR

aeon

DUBAI CREEK HARBOUR

TOWER 1

3 BEDROOMS

FLOORS 16-19 UNIT 01

SUITE AREA	1565.40 SQ.FT.	145.43 SQ.M.
BALCONY AREA	177.96 SQ.FT.	11.84 SQ.M.
TOTAL AREA	1643.36 SQ.FT.	157.27 SQ.M.

KEY PLAN LEVEL
16-19



KEY SECTION



Disclaimer: All dimensions are in imperial and metric, and measured from finish to finish excluding construction tolerances. 2. All materials, dimensions, and drawings are approximate only. 3. Information is subject to change without notice, at developer's absolute discretion. 4. Actual area may vary from the stated area. 5. Drawings not to scale. 6. All images used are for illustrative purposes only and do not represent the actual size, features, specifications, fittings, and furnishings. 7. The developer reserves the right to make revisions / alterations, at its absolute discretion, without any liability whatsoever.

EMAAR

aeon

DUBAI CREEK HARBOUR

TOWER 1

3 BEDROOMS

SUITE 20

SUITE 01

SUITE AREA	1563.50 SQ.FT.	143.44 SQ.M.
BALCONY AREA	177.96 SQ.FT.	11.89 SQ.M.
TOTAL AREA	1741.46 SQ.FT.	157.33 SQ.M.

KEY PLAN LEVEL

20



KEY SECTION



Disclaimer: All dimensions are in imperial and metric, and measured from finish to finish excluding construction tolerances. 2. All materials, dimensions, and drawings are approximate only. 3. Information is subject to change without notice, in developer's absolute discretion. 4. Actual area may vary from the stated area. 5. Drawings not to scale. 6. All images used are for illustrative purposes only and do not represent the actual size, features, specifications, fittings, and furnishings. 7. The developer reserves the right to make revisions / alterations, in its absolute discretion, without any liability whatsoever.

EMAAR

aeon

DUBAI CREEK HARBOUR

TOWER 1

3 BEDROOMS

FLOORS 16-19

UNIT 01

SUITE AREA	1516.48 SQ.FT.	142.79 SQ.M.
BALCONY AREA	731.62 SQ.FT.	67.99 SQ.M.
TOTAL AREA	2248.10 SQ.FT.	210.78 SQ.M.



KEY PLAN LEVEL
16-19



KEY SECTION



Disclaimer: All dimensions are in imperial and metric, and measured from finish to finish excluding construction tolerances. 2. All materials, dimensions, and drawings are approximate only. 3. Information is subject to change without notice, in developer's absolute discretion. 4. Actual area may vary from the stated area. 5. Drawings not to scale. 6. All images used are for illustrative purposes only and do not represent the actual size, features, specifications, fittings, and furnishings. 7. The developer reserves the right to make revisions / alterations, in its absolute discretion, without any liability whatsoever.

EMAAR

aeon

DUBAI CREEK HARBOUR

TOWER 1

3 BEDROOMS

FLOOR 20

UNIT 01

SUITE AREA	1537.84 SQ.FT.	143.87 SQ.M.
BALCONY AREA	733.41 SQ.FT.	68.28 SQ.M.
TOTAL AREA	2271.25 SQ.FT.	212.15 SQ.M.



KEY PLAN LEVEL

20



KEY SECTION



Disclaimer: All dimensions are in imperial and metric, and measured from finish to finish excluding construction tolerances. 2. All materials, dimensions, and drawings are approximate only. 3. Information is subject to change without notice, at developer's absolute discretion. 4. Actual area may vary from the stated area. 5. Drawings not to scale. 6. All images used are for illustrative purposes only and do not represent the actual size, features, specifications, fittings, and furnishings. 7. The developer reserves the right to make revisions / alterations, at its absolute discretion, without any liability whatsoever.

EMAAR

aeon

DUBAI CREEK HARBOUR

TOWER 1

3 BEDROOMS

FLOOR 16-19

SUITE 01

SUITE AREA	1430.31 SQ.FT.	142.67 SQ.M.
BALCONY AREA	246.01 SQ.FT.	22.93 SQ.M.
TOTAL AREA	1746.36 SQ.FT.	164.10 SQ.M.

KEY PLAN LEVEL

16-19



KEY SECTION



Disclaimer: 1. All dimensions are in imperial and metric, and measured from finish to finish excluding construction tolerances. 2. All materials, dimensions, and drawings are approximate only. 3. Information is subject to change without notice, in developer's absolute discretion. 4. Actual area may vary from the stated area. 5. Drawings not to scale. 6. All images used are for illustrative purposes only and do not represent the actual size, features, specifications, fittings, and furnishings. 7. The developer reserves the right to make revisions / alterations, in its absolute discretion, without any liability whatsoever.

EMAAR

aeon

DUBAI CREEK HARBOUR

TOWER 1

3 BEDROOMS

SUITE 20

SUITE 01

SUITE AREA	1531.88 SQ.FT.	143.27 SQ.M.
BALCONY AREA	733.94 SQ.FT.	71.92 SQ.M.
TOTAL AREA	1767.12 SQ.FT.	164.19 SQ.M.

KEY PLAN LEVEL

20



KEY SECTION



Disclaimer: 1. All dimensions are in imperial and metric, and measured from finish to finish excluding construction tolerances. 2. All materials, dimensions, and drawings are approximate only. 3. Information is subject to change without notice, at developer's absolute discretion. 4. Actual area may vary from the stated area. 5. Drawings not to scale. 6. All images used are for illustrative purposes only and do not represent the actual size, features, specifications, fittings, and furnishings. 7. The developer reserves the right to make revisions / alterations, at its absolute discretion, without any liability whatsoever.

EMAAR

aeon

DUBAI CREEK HARBOUR

TOWER 1

3 BEDROOMS

FLOOR 16-19 UNIT 07

SUITE AREA	1333.13 SQ.FT.	143.63 SQ.M.
BALCONY AREA	136.03 SQ.FT.	12.93 SQ.M.
TOTAL AREA	1775.00 SQ.FT.	164.55 SQ.M.

KEY PLAN LEVEL
16-19



KEY SECTION



Disclaimer: All dimensions are in imperial and metric, and measured from finish to finish excluding construction tolerances. 2. All materials, dimensions, and drawings are approximate only. 3. Information is subject to change without notice, at developer's absolute discretion. 4. Actual area may vary from the stated area. 5. Drawings not to scale. 6. All images used are for illustrative purposes only and do not represent the actual size, features, specifications, fittings, and furnishings. 7. The developer reserves the right to make revisions / alterations, at its absolute discretion, without any liability whatsoever.

EMAAR

aeon

DUBAI CREEK HARBOUR

TOWER 1

3 BEDROOMS

LEVEL 20

SUITE 07

SUITE AREA	1514.03 SQ.FT.	142.70 SQ.M.
BALCONY AREA	235.94 SQ.FT.	21.92 SQ.M.
TOTAL AREA	1775.95 SQ.FT.	164.67 SQ.M.

KEY PLAN LEVEL

20



KEY SECTION



Disclaimer: All dimensions are in imperial and metric, and measured from finish to finish excluding construction tolerances. 2. All materials, dimensions, and drawings are approximate only. 3. Information is subject to change without notice, in developer's absolute discretion. 4. Actual area may vary from the stated area. 5. Drawings not to scale. 6. All images used are for illustrative purposes only and do not represent the actual size, features, specifications, fittings, and furnishings. 7. The developer reserves the right to make revisions / alterations, in its absolute discretion, without any liability whatsoever.

EMAAR

aeon

DUBAI CREEK HARBOUR

TOWER 1

3 BEDROOMS

FLOOR 16-19 UNIT 06

SUITE AREA	1529.77 SQ.FT.	142.17 SQ.M.
BALCONY AREA	731.82 SQ.FT.	67.99 SQ.M.
TOTAL AREA	2261.59 SQ.FT.	210.17 SQ.M.

KEY PLAN LEVEL
16-19



KEY SECTION



Disclaimer: All dimensions are in imperial and metric, and measured from finish to finish excluding construction tolerances. 2. All materials, dimensions, and drawings are approximate only. 3. Information is subject to change without notice, at developer's absolute discretion. 4. Actual area may vary from the stated area. 5. Drawings not to scale. 6. All images used are for illustrative purposes only and do not represent the actual size, features, specifications, fittings, and furnishings. 7. The developer reserves the right to make revisions / alterations, at its absolute discretion, without any liability whatsoever.

EMAAR

aeon

DUBAI CREEK HARBOUR

TOWER 1

3 BEDROOMS

FLOOR 20

FLOOR 20

SUITE AREA	1530.63 SQ.FT.	142.20 SQ.M.
BALCONY AREA	731.32 SQ.FT.	67.39 SQ.M.
TOTAL AREA	2261.95 SQ.FT.	209.59 SQ.M.



KEY PLAN LEVEL

20



KEY SECTION



Disclaimer: All dimensions are in imperial and metric, and measured from finish to finish excluding construction tolerances. 2. All materials, dimensions, and drawings are approximate only. 3. Information is subject to change without notice, at developer's absolute discretion. 4. Actual area may vary from the stated area. 5. Drawings not to scale. 6. All images used are for illustrative purposes only and do not represent the actual size, features, specifications, fittings, and furnishings. 7. The developer reserves the right to make revisions / alterations, at its absolute discretion, without any liability whatsoever.

EMAAR

Get In Touch

We'd love to hear from you. Contact us and let's discuss all your property needs.

Uruk Properties Head Office

Tel: +971 4 263 0888

Mob: +971 56 400 1413

Email: info@urukproperties.com

Office 1001, DAMAC Smart Heights
7 Al Nahar 2 St., - Barsha Heights - Dubai

URUK
PROPERTIES

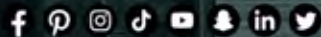

UrukProperties

www.urukproperties.com